

STAINLESS STEEL 304 PRESS FIT FITTINGS (M PROFILE)

COMPLY WITH BSEN1254-2: 1998
AS 3688: 2005
AS/NZS 4020: 2005
SS 375: 2015
SS 270: 2015

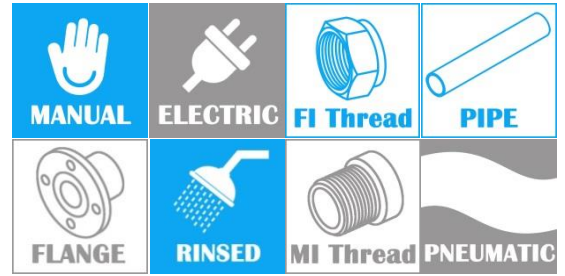

MI 90° ELBOW

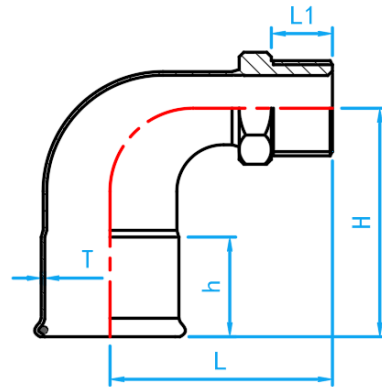

CROSS SECTIONAL VIEW

DIMENSIONS

SKU	SIZE (mm × inch)	H (mm)	L (mm)	h (mm)	L1 (mm)	T (mm)	WEIGHT (kg)	PCS/CTN
SSPFNMIE01515	15 × 1/2" BSPT	42.0	53.0	20	15	1.5	0.060	300
SSPFNMIE02015	22 × 1/2" BSPT	51.0	60.0	21	15	1.5	0.080	200
SSPFNMIE02020	22 × 3/4" BSPT	51.0	61.0	21	16	1.5	0.092	160
SSPFNMIE02515	28 × 1/2" BSPT	60.0	71.0	23	19	1.5	0.120	100
SSPFNMIE02525	28 × 1" BSPT	60.0	78.0	23	19	1.5	0.145	70
SSPFNMIE03515	35 × 1/2" BSPT	72.0	78.0	26	15	1.5	0.162	50
SSPFNMIE03525	35 × 1" BSPT	72.0	80.0	26	19	1.5	0.180	50
SSPFNMIE03535	35 × 1 1/4" BSPT	72.0	77.0	26	21	1.5	0.215	55
SSPFNMIE04225	42 × 1" BSPT	85.0	101.0	26	19	1.5	0.270	50
SSPFNMIE04242	42 × 1 1/2" BSPT	85.0	111.0	31	21	1.5	0.300	33
SSPFNMIE05025	54 × 1" BSPT	105.0	114.0	36	19	1.5	0.376	50
SSPFNMIE05050	54 × 2" BSPT	105.0	129.0	36	26	1.5	0.495	21
SSPFNMIE06565	67 × 2 1/2" BSPT	114.0	131.5	50	26	2.0	0.970	12